



 2  1  1  C

Gillsmans Hill, St. Leonards-On-Sea, TN38 0SP

£1,100 Per Calendar Month



Oliver & Bailey

01424 834000 | 01424 533 555

Info@oliverbaileylettings.co.uk
www.oliverbaileylettings.co.uk

Entrance hall

Living room

14'4" x 10'11" (4.39m x 3.33m)

Kitchen

10'11" x 9'4" (3.33m x 2.87m)

Bedroom One

13'1" x 10'2" (4.01m x 3.10m)

Bedroom Two

11'6" x 8'11" (3.51m x 2.74m)

Bathroom

Balcony



Furnished Options: Unfurnished

Council Tax Band: C

Available Date: 22nd August 2025

**Oliver
& Bailey**

TWO BEDROOM WITH PRIVATE BALCONY AND OFF ROAD PARKING... Call Georgia or Robyn at Oliver & Bailey to view this well presented two bedroom top floor apartment.

Located just off Gillman's Hill, the property is tucked away on a private development surrounded by woodland and boasts one off road parking space.

Comprising two double bedrooms, a living room with access to private balcony, kitchen with built in appliances to include washing machine, dishwasher, fridge freezer and oven/hob, there is also a modern fitted bathroom with shower over bath.

Further benefits to the property are gas central heating, double glazing and an EPC rating of C.

FLOORPLAN

GROUND FLOOR
550 sq.ft. (51.1 sq.m.) approx.

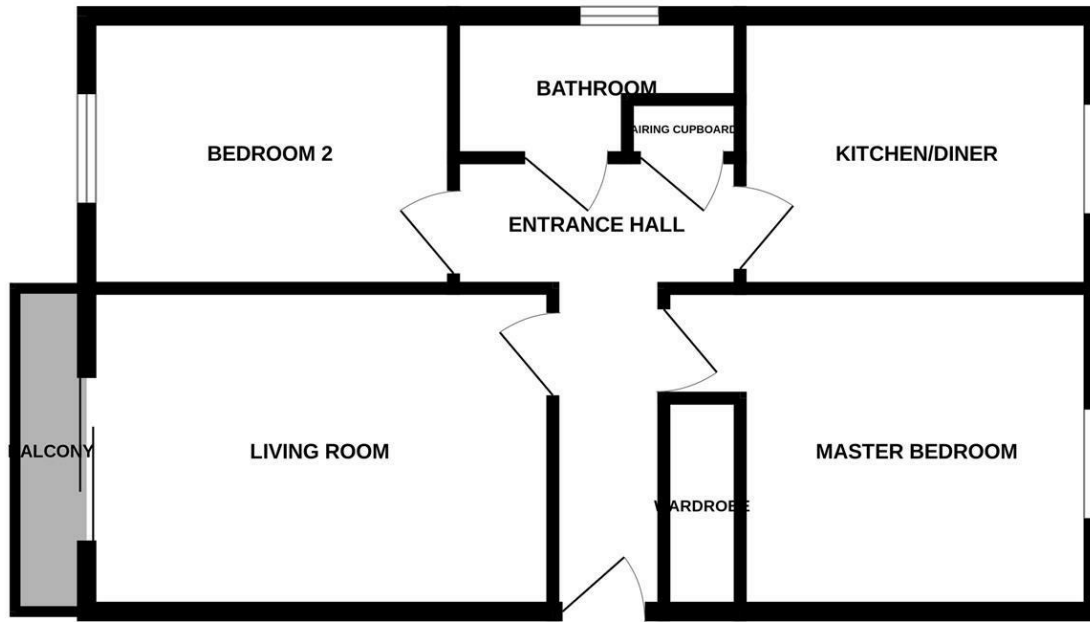

TOTAL FLOOR AREA : 550 sq.ft. (51.1 sq.m.) approx.

Whilst every attempt has been made to ensure the accuracy of the floorplan contained here, measurements of doors, windows, rooms and any other items are approximate and no responsibility is taken for any error, omission or mis-statement. This plan is for illustrative purposes only and should be used as such by any prospective purchaser. The services, systems and appliances shown have not been tested and no guarantee as to their operability or efficiency can be given.
Made with Metropix ©2024

AREA MAP

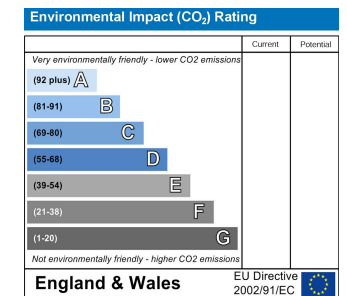
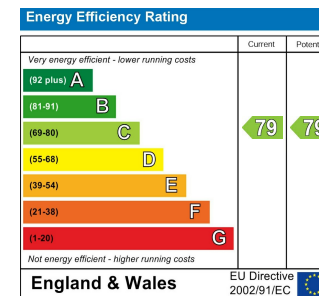
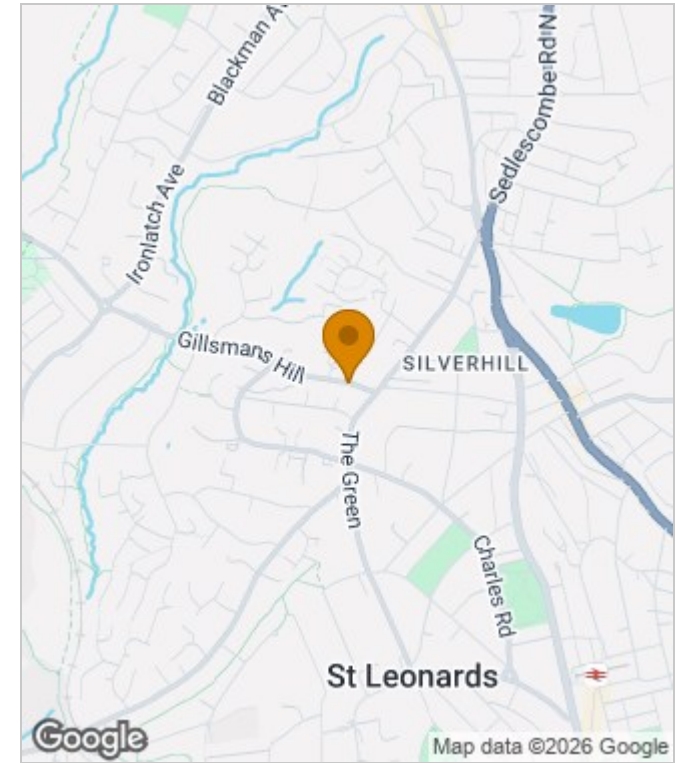

These particulars, whilst believed to be accurate are set out as a general outline only for guidance and do not constitute any part of an offer or contract. Intending purchasers should not rely on them as statements of representation of fact, but must satisfy themselves by inspection or otherwise as to their accuracy. No person in this firm's employment has the authority to make or give any representation or warranty in respect of the property.